



GVM-1101 Version: 1

## RJ45 to SC Managed Gigabit Media Converter, Multi-Mode Fiber

### Key Features

- Multi-mode fiber with SC connector for transmission of up to 500m
- Supports VLAN (tag-based, Q-in-Q)
- Web-based and SNMP Management
- Built-in LFP (Link Fault Pass-through) (LLCF/LLR) Technology
- IEEE 802.3x Flow Control protects against lost packets for reliable data transmission
- Support Operations, Administration, and Maintenance (OAM) mechanisms

### Specifications

#### System Specifications

##### Standards & Protocols:

IEEE802.3 10Base-T Ethernet  
IEEE802.3u 100Base-TX Fast Ethernet  
IEEE802.3ab 1000Base-T Giga Ethernet  
IEEE802.3z 1000Base-X Giga Ethernet  
IEEE802.3x Flow Control  
IEEE802.3ah OAM

##### Port:

1 x RJ45 Ethernet port,  
1 x SC/ST/FC fiber connector

##### Indicator:

PWR (power supply),  
FX LINK/ACT (optical link action)  
FDX (full duplex),  
TX LINK/ACT (TP cable link/action)  
TX SPD (TP cable rate),  
LFP(LFP function enable/disable)

##### Wavelength (nm):

850nm

##### Transmission Method:

store and forward or cut-through by software configure



#### Power Input:

internal: 100~240VAC in, 5V@2A output

### Features

#### General:

1. 10/100/1000Mbps auto-sensed, facilitating network upgrade
2. Support LFP function
3. Built-in efficient switching core to implement flow control and reduce broadcast packets
4. Full-duplex and half-duplex auto-sensed
5. Support SC/ST/FC connector
6. Support Jumbo frame up to 9k bytes
7. Support Q-in-Q function, Optical port and Ethernet port can be set separately as dual Tag ports, and can be set as ISP Tag and ISP Tag TPID
8. Support configure the operation mode of each port on local and remote devices, including port speed, full/half-duplex, and flow control, etc, and can display the real-time status of each port
9. Support bandwidth-limiting function: with the step of 64kps, the bandwidth can be set between 0Mbps and 1000Mbps
10. Support 4 kinds of 802.3ah OAM functions: Discover of OAM, MIB variable response, OAM Loopback, Dying Gasp alarm
11. Offer MIB library files, support OpenView?Snmpc, and other softwares

### Performance

#### Operating Distance:

500m

### Environment

#### Temperature (°C):

-10~55

#### Humidity (Non-condensing):

5%~90% non-condensing

#### Installation:

Desk, Wall mounted

### Physical Specifications

#### Dimensions (W x D x H mm):

127mm×156mm×32mm

#### Weight (g):

720

### Reliability

#### MTBF:

30000hours

### Approval and Compliance

#### EMI/EMS:

CE, RoHS, FCC

# Diagram

## Dimension Diagram

— Cat.5 UTP  
— Fiber

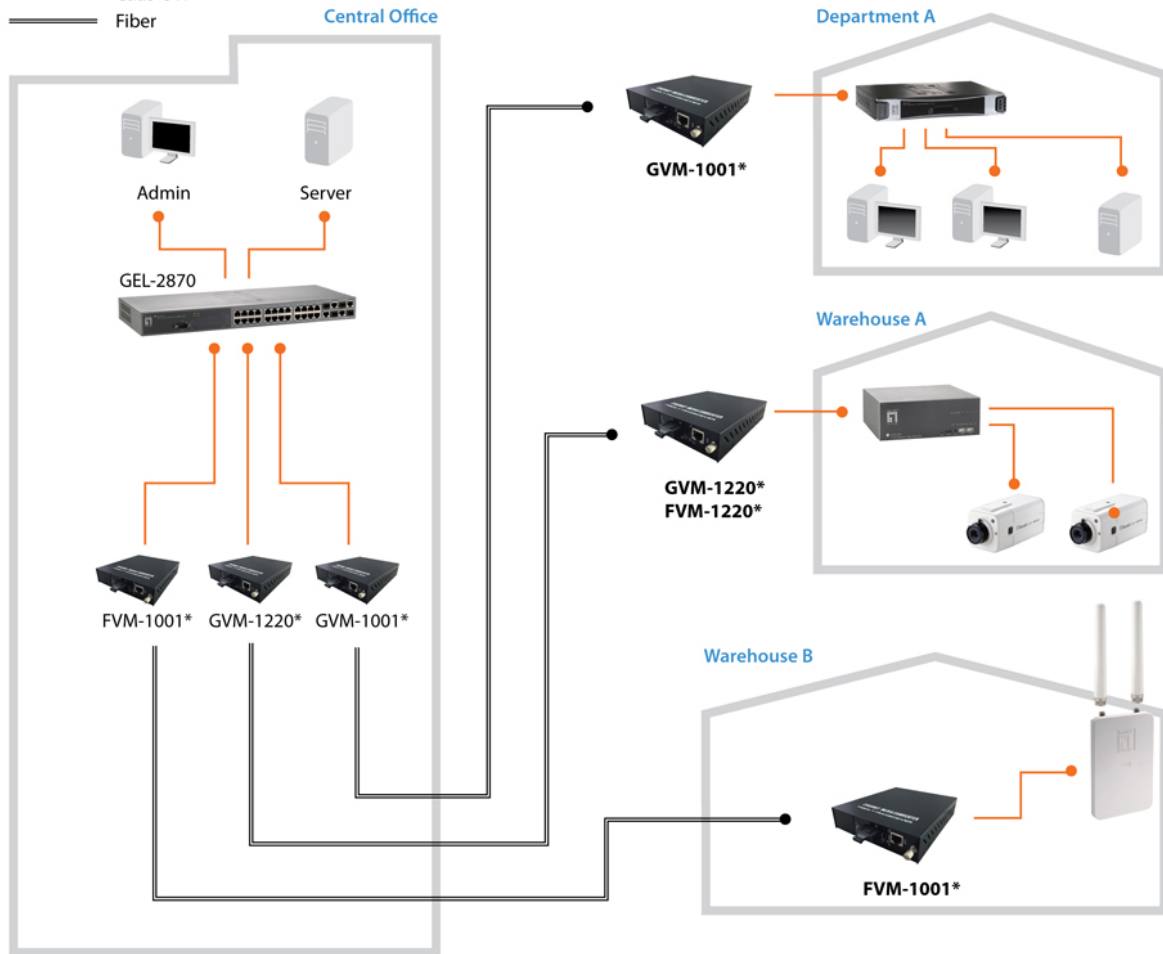

\*In above example diagram, converter modules at local and remote ends should be paired for proper connectivity, and the distance mainly depends on cable and transceiver selection accordingly.

---

## Order Information

GVM-1101

---

## Package Contents

GVM-1101  
Resource CD (User Manual)

No liability or responsibility for any errors or omissions in the content.  
Specifications are subject to change without notice.  
All mentioned brand names are registered trademarks and property of their owners.  
Copyright © Digital Data Communications GmbH, Germany. All Rights Reserved.